



Manufacturer of Electrical Hair Appliances

Add:2/F,Building3,Hengmingzhu Science & Technology Park, Tongfuyu Industrial Zone,Gonghe,
Shajing,Bao'an,Shenzhen 518104,China.

Tel:0086-755-29091864/29091865

Fax:0086-755-22632328

Email:ellentan@lady-merry.com

www.lady-merry.com

<http://lady-merry.en.alibaba.com>

Manufacturer of Electrical Hair Appliances

C

ONTENTS

HAIR STRAIGHTENER	04
CURLING IRON	22
HAIR BRUSH	30
MINI	33
NANO FABRIC	38
ACCESSARIES	39
> SILICONE SLEEVE	39
> HOLDER	40
> POUCH	41
> GLOVE	43



• Industrial park



• R&D center



• Reception

Company Profile

Founded in 2010, Shenzhen Lady Merry Technology Co. Ltd. set out itself to be one of the leading suppliers and factories in Shenzhen China, specialised in all kinds of hair straighteners, curling irons and thermal brushes.

Ladymerry is ISO9001 certified, and all the products are with CETLUS,CTUVUS,CE,ROHS and other required safety certifications for each local customers. Our focus is to offer salon quality products with advanced technology and service to meet different clients' demand. To ensure the high performance, we have a strong and experienced R&D team as well as a strict quality control system.

With a new manufacturing site and introduction of 'U' shape production lines in 2018, our monthly max production capacity can reach 400000pcs. Till now, we have gained great partnership with many brands and companies worldwide.

OEM and ODM are available and welcome, and long-term relationship will be always appreciated.

Company Strategy

- Mission To become a famous manufacturer of hair tools, build a world-class business
- Principles Dedication, teamwork and innovation
- Philosophy
 - To provide value for customers
 - To provide opportunities for employees
 - To provide benefits for society



Certificate of Utility Model Patent



Certificate of Design Patent

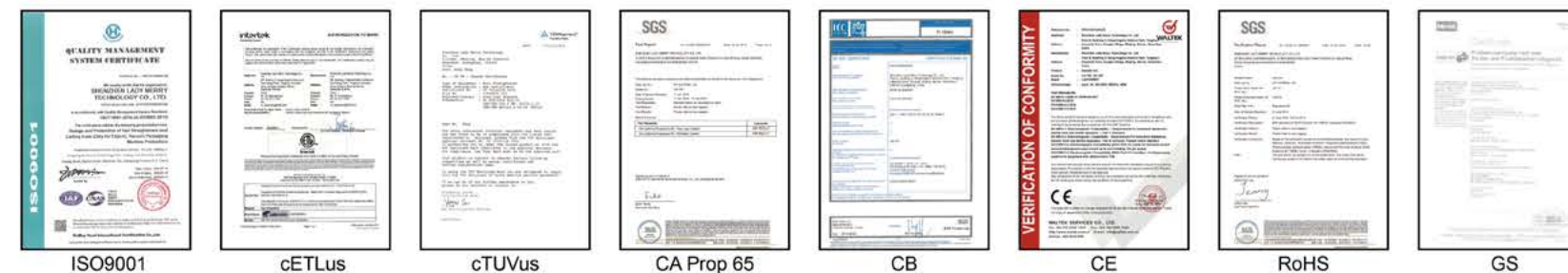

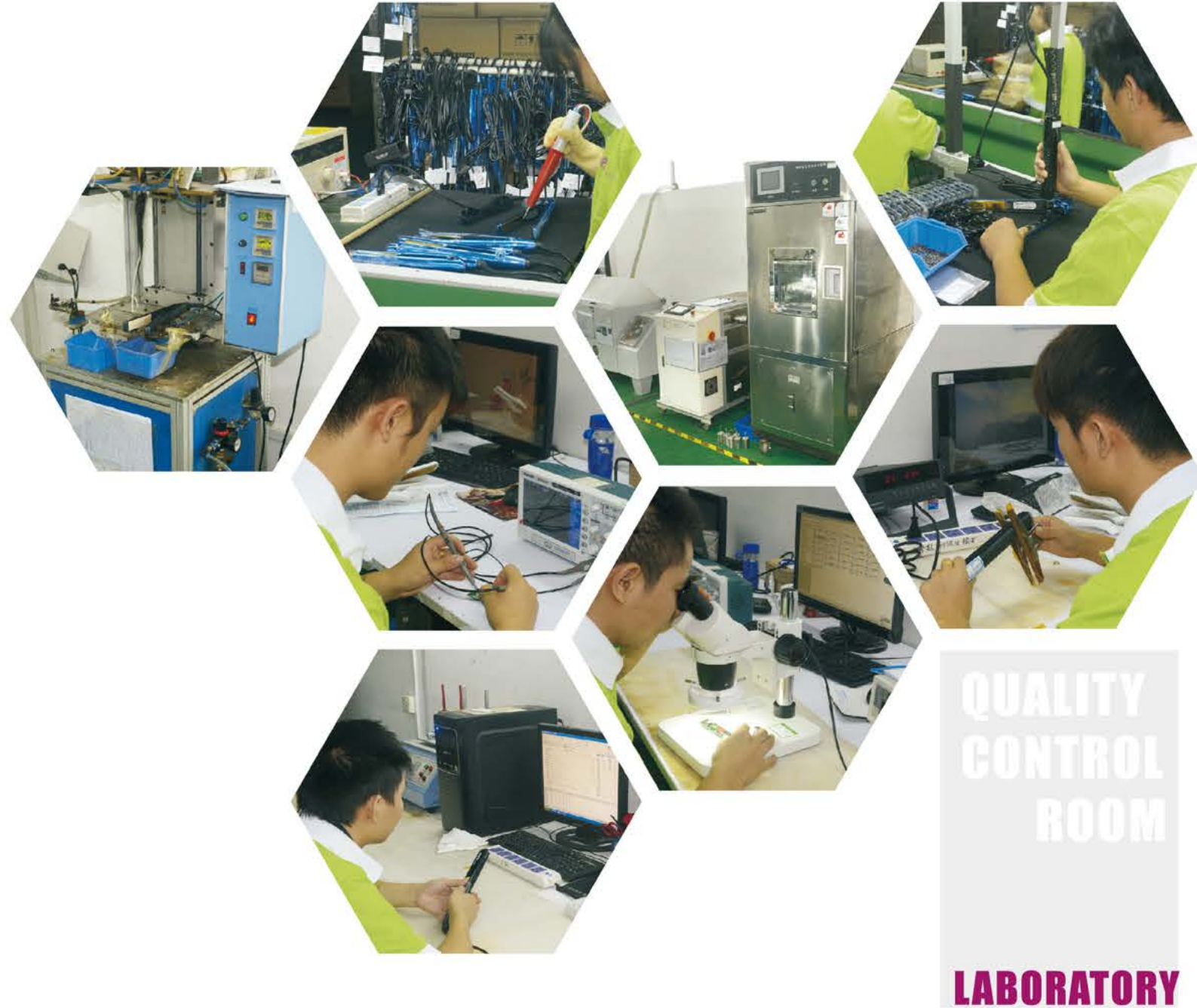

FACTORY TOUR





LM-166

Unique cylinder hair straightener

Plate size: 26x90mm
Product size: 285x31x36mm



LM-186

Unique cylinder hair straightener

- ◆ Dual voltage 100-240V AC
- ◆ 3D floating plates for easier styling
- ◆ 5 temperature levels, 250-320-355-410-450°F
- ◆ MCH heating element
- ◆ Lock function for easier storage
- ◆ 2.5 meters 360° swivel cord
- ◆ Cool front tip for safer touch
- ◆ Automatic shut-off in one hour
- ◆ Plate size: 26x90mm
- ◆ Product size: 285x31x36mm



LM-188

Private new salon grade hair straightener

- ◆ Dual voltage 100-240V AC
- ◆ 3D floating plates for easier styling
- ◆ LED digital display, 130°C(265°F)-230°C(450°F)
- ◆ MCH heater, 60s to 200°C(395°F)
- ◆ All in one rotating sleeve control at the rear
- ◆ 2.5 meters 360° swivel cord
- ◆ Lock function on the bottom for better storage
- ◆ Automatic shut-off in one hour
- ◆ Plate size: 29.5x110mm
- ◆ Product size: 326x38x36mm

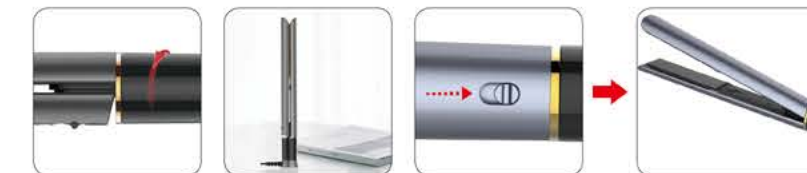

HAIR STRAIGHTENER



LM-167

Touch sense technology

- ◆ Dual voltage 100-240V AC
- ◆ Touch 1.5s to turn on/off, touch "+/-" to adjust temperature
- ◆ 5 temperature settings, 130°C(265°F)-150°C(300°F)-180°C(355°F)-200°C(395°F)-230°C(450°F)
- ◆ 3D floating plates for easier styling
- ◆ MCH heating element
- ◆ 2.5 meters 360° swivel cord
- ◆ Automatic shut-off in one hour
- ◆ Plate size: 24x90mm
- ◆ Product size: 285x31x36mm

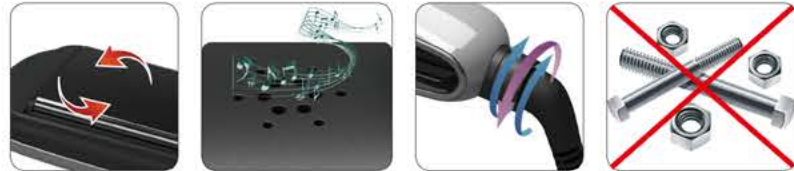

LM-167A/167B

LED digital touch sense technology

- ◆ Dual voltage 100-240V AC
- ◆ Touch 1.5s to turn on/off, touch "+/-" to adjust temperature
- ◆ Temperature lock function after 3s of inactivity
- ◆ Swipe interface to unlock
- ◆ 3D floating plates for easier styling
- ◆ Real-time digital display, 130°C(265°F) -230°C(450°F)
- ◆ MCH heating element
- ◆ 2.5 meters 360° swivel cord
- ◆ Automatic shut-off in one hour
- ◆ Plate size: 24x90mm
- ◆ Product size: 285x31x36mm



LM-175

Private new salon grade hair straightener

- ◆ Dual voltage 100-240V AC
- ◆ 3D floating plates for easier styling
- ◆ 5 pre-programmed digital settings
- ◆ MCH heater, 60s to 200°C(395°F)
- ◆ All in one button control, easy operation
- ◆ 2.5 meters 360° swivel cord
- ◆ Automatic shut-off in one hour
- ◆ Plate size: 24x90mm
- ◆ Product size: 285x31x36mm



HAIR STRAIGHTENER



LM-175A

Private new salon grade hair straightener

- ◆ Dual voltage 100-240V AC
- ◆ 3D floating plates for easier styling
- ◆ LED digital display, 130°C(265°F)-230°C(450°F)
- ◆ MCH heater, 60s to 200°C(395°F)
- ◆ All in one button control, easy operation
- ◆ 2.5 meters 360° swivel cord
- ◆ Automatic shut-off in one hour
- ◆ Plate size: 24x90mm
- ◆ Product size: 285x31x36mm



**LM-171****NEW 1" professional hair straightener**

- ◆ Dual voltage 100-240V AC
- ◆ 3D floating plates for easier styling
- ◆ MCH/PTC heating element
- ◆ 5 temperature levels 130°C(265°F)-230°C(450°F)
- ◆ All-in-one button control for easy styling
- ◆ 2.5 meters 360° swivel cord
- ◆ Automatic shut-off in one hour
- ◆ Plate size: 25x100mm
- ◆ Product size: 278x31.5x32mm

**LM-173****NEW 1.5" professional hair straightener**

- ◆ Dual voltage 100-240V AC
- ◆ 3D floating plates for easier styling
- ◆ MCH/PTC heating element
- ◆ 5 temperature levels 130°C(265°F)-230°C(450°F)
- ◆ All-in-one button control for easy styling
- ◆ 2.5 meters 360° swivel cord
- ◆ Automatic shut-off in one hour
- ◆ Plate size: 37.5x100mm
- ◆ Product size: 278x43.5x32mm

**LM-127****Newest technology, Flash heat-recovery**

- ◆ Dual voltage 100-240V AC
- ◆ 3D floating plates for easier styling
- ◆ Intelligent 3 color indicators
- ◆ LED digital adjustable temperature 130°C(265°F)-230°C(450°F)
- ◆ MCH/PTC heating element
- ◆ Automatic shut-off in one hour
- ◆ 2.5 meters 360° swivel cord
- ◆ Plate size: 28x100mm
- ◆ Product size: 290*32*38mm

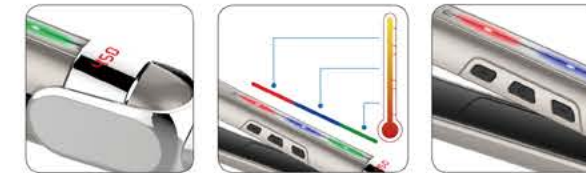
**LM-185****Private cool steam hair straightener**

- ◆ Dual voltage 100-240V AC
- ◆ 3D floating plates for easier styling
- ◆ PTC heating element
- ◆ LED digital with dial control in real-time display
- ◆ Wide temperature range, 130°C(265°F)-230°C(450°F)
- ◆ Steam on-off switch control
- ◆ Lock function on the tail for better storage
- ◆ 2.5 meters 360° swivel cord
- ◆ Automatic shut-off in one hour
- ◆ Plate size: 24.5x108mm
- ◆ Product size: 308x40x52mm





LM-152

Extra-long design, digital LED with lighted temperature display

- ◆ Dual voltage 100-240V AC
- ◆ Ceramic tourmaline or titanium plates
- ◆ Three lighted temperature display
- ◆ LED digital temperature control 130°C(265°F)-230°C(450°F)
- ◆ Lock function on the tail for easier and better storage
- ◆ Automatic shut-off in one hour
- ◆ 2.5 meters 360° swivel cord
- ◆ Optional negative ion generating function
- ◆ Plate size: 24.5x110mm
- ◆ Product size: 305*29*34mm



LM-177

2" hair straightener

- ◆ Dual voltage 100-240V AC
- ◆ 3D floating plates for easier styling
- ◆ MCH heating element
- ◆ LED digital temperature display
- ◆ Wide temperature range, 130°C(265°F)-230°C(450°F)
- ◆ Lock function for better storage
- ◆ Automatic shut-off in one hour
- ◆ Longer and wider plate size: 50x110mm
- ◆ Optional plates: Crimper, Infrared
- ◆ Product size: 305x56x35mm



LM-160

Professional ultra long slim hair straightener

- ◆ Dual voltage 100-240V AC
- ◆ 3D floating plates for easier styling
- ◆ LED digital display, 130°C(265°F)-230°C(450°F)
- ◆ MCH/PTC heating element
- ◆ Ceramic tourmaline or titanium plates
- ◆ Automatic shut-off in one hour
- ◆ 2.5 meters 360° swivel cord
- ◆ Plate size: 24x110mm
- ◆ Product size: 300*28*30mm



LM-134

2" hair straightener

- ◆ Dual voltage 100-240V AC
- ◆ 3D floating plates for easier styling
- ◆ MCH heating element
- ◆ LED digital temperature display
- ◆ Wide temperature range, 130°C(265°F)-230°C(450°F)
- ◆ 2.5 meters 360° swivel cord
- ◆ Automatic shut-off in one hour
- ◆ Longer and wider plate size: 50x110mm
- ◆ Optional plates: Crimper, Infrared
- ◆ Product size: 300x56x31.5mm





LM-130

Professional ultra long slim hair straightener

- ◆ Dual voltage 100-240V AC
- ◆ 3D floating plates for easier styling
- ◆ 5 pre-programmed digital settings 130°C(265°F)-230°C(450°F)
- ◆ MCH/PTC heating element
- ◆ Ceramic tourmaline or titanium plates
- ◆ Automatic shut-off in one hour
- ◆ 2.5 meters 360° swivel cord
- ◆ Plate size: 24x110mm
- ◆ Product size: 300x28x30mm

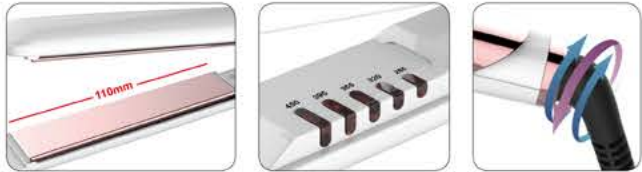

LM-131

Wide professional ultra long slim hair straightener

- ◆ Dual voltage 100-240V AC
- ◆ 3D floating plates for easier styling
- ◆ 5 pre-programmed digital settings 130°C(265°F)-230°C(450°F)
- ◆ MCH/PTC heating element
- ◆ Ceramic tourmaline or titanium plates
- ◆ Automatic shut-off in one hour
- ◆ 2.5 meters 360° swivel cord
- ◆ Plate size: 38x110mm
- ◆ Product size: 298*30*43.3mm



LM-132

Digital professional ultra long slim hair straightener

- ◆ Dual voltage 100-240V AC
- ◆ 3D floating plates for easier styling
- ◆ LED digital display, 130°C(265°F)-230°C(450°F)
- ◆ MCH/PTC heating element
- ◆ Ceramic tourmaline or titanium plates
- ◆ Automatic shut-off in one hour
- ◆ 2.5 meters 360° swivel cord
- ◆ Plate size: 24x110mm
- ◆ Product size: 300*28*30mm



LM-136

Digital hair straightener with dial-pad temperature control

- ◆ Dual voltage 100-240V AC
- ◆ Ceramic tourmaline or titanium plates
- ◆ LCD displaying temperature 130°C(265°F)-230°C(450°F)
- ◆ MCH/PTC heating element
- ◆ Optional negative ion generating function
- ◆ Automatic shut-off in one hour
- ◆ 2.5 meters 360° swivel cord
- ◆ Plate size: 24x90mm
- ◆ Product size: 274*36*37.5mm





LM-151

LCD display with dial-pad temperature control

- ◆ Dual voltage 100-240V AC
- ◆ 3D floating plates for easier styling
- ◆ LCD display temperature 130°C(265°F)-230°C(450°F)
- ◆ MCH/PTC heating element
- ◆ Automatic shut-off in one hour
- ◆ Lock function on the tail
- ◆ Optional negative ion generating function
- ◆ 2.5 meters 360° swivel cord
- ◆ Plate size: 24x100mm
- ◆ Product size: 279x39.5x33.5mm



LM-107

Professional long slim design hair straightener

- ◆ Dual voltage 100-240V AC
- ◆ Tourmaline ceramic or titanium plates for shiny result
- ◆ MCH/PTC heating element
- ◆ LCD adjustable temperature 130°C(265°F)-220°C(430°F)
- ◆ 1.8 meters 360° swivel cord
- ◆ Automatic shut-off in one hour
- ◆ Plate size: 25.4x110mm
- ◆ Product size: 278x29.5x28mm



LM-116

Professional LED dial control hair straightener

- ◆ Dual voltage 100-240V AC
- ◆ 3D floating plates for easier styling
- ◆ MCH/PTC heating element
- ◆ Adjustable temperature 120°C(250°F)-230°C(450°F)
- ◆ Automatic shut-off in one hour
- ◆ 2.5 meters 360° swivel cord
- ◆ Plate size: 24x90mm
- ◆ Product size: 268x32x39mm



LM-117

Professional LED dial control hair straightener

- ◆ Dual voltage 100-240V AC
- ◆ 3D floating plates for easier styling
- ◆ MCH/PTC heating element
- ◆ Adjustable temperature 120°C(250°F)-230°C(450°F)
- ◆ Automatic shut-off in one hour
- ◆ 2.5 meters 360° swivel cord
- ◆ Plate size: 32x100mm
- ◆ Product size: 277x37x40mm





Optional Vibrating System

LM-115

Professional long slim design hair straightener

- ◆ Dual voltage 100-240V AC
- ◆ Optional vibrating function for friction free
- ◆ MCH/PTC heating element
- ◆ LCD adjustable temperature 130°C(265°F)-230°C(450°F)
- ◆ Automatic shut-off in one hour
- ◆ 2.5 meters 360° swivel cord
- ◆ Plate size: 25.4x115mm
- ◆ Product size: 300x33x35mm



Optional Vibrating System

LM-118

Professional long slim design hair straightener

- ◆ Dual voltage 100-240V AC
- ◆ MCH/PTC heating element
- ◆ LCD adjustable temperature 130°C(265°F)-230°C(450°F)
- ◆ 2.5 meters 360° swivel cord
- ◆ Automatic shut-off in one hour
- ◆ Optional vibrating function for friction free
- ◆ Plate size: 25.4x115mm
- ◆ Product size: 300x33x35mm

**LM-118A LED**

Professional long slim design hair straightener

- ◆ Dual voltage 100-240V AC
- ◆ PTC heating element
- ◆ LED adjustable temperature 140°C(285°F)-230°C(450°F)
- ◆ Automatic shut-off in one hour
- ◆ 2.5 meters 360° swivel cord
- ◆ Plate size: 25.4x115mm
- ◆ Product size: 300x33x35mm

**LM-118A LCD**

Professional long slim design hair straightener

- ◆ Dual voltage 100-240V AC
- ◆ MCH/PTC heating element
- ◆ LCD adjustable temperature 130°C(265°F)-230°C(450°F)
- ◆ Automatic shut-off in one hour
- ◆ 2.5 meters 360° swivel cord
- ◆ Plate size: 25.4x115mm
- ◆ Product size: 300x33x35mm



**LM-119****Professional LED dial control hair straightener**

- ◆ Dual voltage 100-240V AC
- ◆ 3D floating plates for easier styling
- ◆ MCH/PTC heating element
- ◆ Adjustable temperature 120°C(250°F)-230°C(450°F)
- ◆ One hour auto shut-off
- ◆ 2.5 meters 360° swivel cord
- ◆ Plate size: 24x90mm
- ◆ Product size: 277x33x40mm

**LM-120****Professional LED dial control hair straightener**

- ◆ Dual voltage 100-240V AC
- ◆ 3D floating plates for easier styling
- ◆ MCH/PTC heating element
- ◆ Adjustable temperature 120°C(250°F)-230°C(450°F)
- ◆ Automatic shut-off in one hour
- ◆ 2.5 meters 360° swivel cord
- ◆ Plate size: 24x90mm
- ◆ Product size: 277x33x45mm

**LM-121****Salon-grade slim hair straightener**

- ◆ Dual voltage 100-240V AC
- ◆ Ergonomic design with no screws from the appearance
- ◆ 3D floating plates for easier styling
- ◆ MCH/PTC heating element
- ◆ LCD temperature control from 130°C(265°F)-230°C(450°F)
- ◆ Automatic shut-off in one hour
- ◆ 2.5 meters 360° swivel cord
- ◆ Plate size: 24x90mm
- ◆ Product size: 270x32.9x32mm

**LM-124****Compact-size hair straightener**

- ◆ Dual voltage 100-240V AC
- ◆ 3D floating plates for easier styling
- ◆ MCH/PTC heating element
- ◆ Three types of temperature control: on-off switch, dial and button pressing
- ◆ Automatic shut-off in one hour
- ◆ 1.8 meters 360° swivel cord
- ◆ Plate size: 24x90mm
- ◆ Product size: 253x31x35mm





LM-122(28mm)/123(35mm)

Professional LED digital hair straightener in two sizes

- ◆ Dual voltage 100-240V AC
- ◆ 3D floating plates for easier styling
- ◆ MCH/PTC heating element
- ◆ LED digital temperature control, 130°C(265°F)-230°C(450°F)
- ◆ Automatic shut-off in one hour
- ◆ 2.5 meters 360° swivel cord
- ◆ Plate size: 28x100mm, 35x100mm
- ◆ Product size: 288x33.4x54.5mm
- ◆ Extra WET-TO-DRY plates
- ◆ Extra Infra-red function

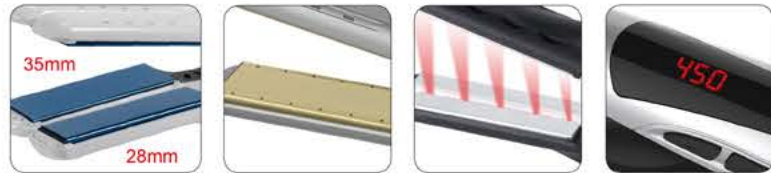

LM-128

Professional LCD display hair straightener

- ◆ Ergonomic design for comfortable use
- ◆ Dual voltage 100-240V AC
- ◆ 3D floating plates for easier styling
- ◆ LCD temperature control 130°C(265°F)-230°C(450°F)
- ◆ MCH/PTC heating element
- ◆ Automatic shut-off in one hour
- ◆ 2.5 meters 360° swivel cord
- ◆ Plate size: 28x90mm
- ◆ Product size: 275*30*37mm



LM-129

Digital hair straightener with special CONDITIONING function

- ◆ Dual voltage 100-240V AC
- ◆ Nano silk fabric technology
- ◆ LCD displaying temperature 50°C(120°F)-230°C(450°F)
- ◆ MCH/PTC heating element
- ◆ Automatic shut-off in one hour
- ◆ 2.5 meters 360° swivel cord
- ◆ Plate size: 28x90mm
- ◆ Product size: 290*32*38mm





LM-223

LED display knob control temperature

Various barrel size : 19mm, 25mm, 28mm, 32mm, 38mm
Various barrel shapes and sizes available for choice



LM-239

Private new salon grade hair straightener

- ◆ Dual voltage 100-240V AC
- ◆ Tourmaline ceramic or titanium barrel
- ◆ MCH heating element
- ◆ Adjustable temperatures, 130°C(265°F)-220°C(430°F)
- ◆ LED digital display
- ◆ 2.5 meters 360° swivel cord
- ◆ Cool front tip for safer touch
- ◆ Automatic shut-off in one hour
- ◆ Barrel size: 26x110mm
- ◆ Product size: 330x59x27mm



LM-256

New professional curling iron bar

- ◆ Dual voltage 100-240V AC
- ◆ Tourmaline ceramic or titanium barrel
- ◆ PTC heating element
- ◆ LED digital temperature display 130°C(265°F)-220°C(430°F)
- ◆ Temperature interval at 50°F
- ◆ Release wrist, easier and safer styling
- ◆ 1.8 meters cord for styling
- ◆ Automatic shut-off in one hour
- ◆ Product size: 212x193x49.5mm





LM-223

LED display knob control temperature

- ◆ Dual voltage 100-240V AC
- ◆ Tourmaline ceramic or titanium barrel
- ◆ LED digital display, 130°C(265°F)-220°C(430°F)
- ◆ Ceramic heaters provide a uniform heat distribution heat recovery
- ◆ 2.5 meters 360° swivel cord
- ◆ Automatic shut-off in one hour
- ◆ Various barrel size: 19mm, 26mm, 32mm
- ◆ Various barrel shapes and sizes available for choice



LM-228

Private new salon grade curling iron

- ◆ Dual voltage 100-240V AC
- ◆ Tourmaline ceramic or titanium barrel
- ◆ PTC heating element
- ◆ 3 pre-programmed digital settings
150°C(300°F)-180°C(355°F)-220°C(430°F)
- ◆ All-in-one button control for easy styling
- ◆ Automatic shut-off in one hour
- ◆ 2.5 meters 360° swivel cord
- ◆ Optional barrel sizes: 10/19/25/38mm



LM-220(LED)/221(Digital)

Curling tong with unified simple design

- ◆ Dual voltage 100-240V AC
- ◆ One button for power-on/off and to control temperatures
- ◆ PTC heating element
- ◆ 5 temperature levels 140°C(285°F)-220°C(430°F) /
LED digital display, 130°C(265°F)-220°C(430°F)
- ◆ Automatic shut-off in one hour
- ◆ 2.5 meters 360° swivel cord
- ◆ Various barrel size: 19mm, 25mm, 28mm, 32mm, 38mm
- ◆ Various barrel shapes and sizes available for choice



LM-220A(LED)/221A(Digital)

INTERCHANGEABLE curling iron for different use

- ◆ Dual voltage 100-240V AC
- ◆ One button for power-on/off and to control temperatures
- ◆ PTC heating element
- ◆ 5 temperature levels 140°C(285°F)-220°C(430°F) /
LED digital display, 130°C(265°F)-220°C(430°F)
- ◆ Various barrel shapes and sizes available for choice
- ◆ Automatic shut-off in one hour
- ◆ 2.5 meters 360° swivel cord
- ◆ Various barrel size: 19mm/25mm/32mm tong
25mm/32mm wand 19mm/25mm/32mm spring





LM-102

Professional curling wand

- ◆ Dual voltage 100-240V AC
- ◆ Rapid heating up and constant recovery
- ◆ LCD adjustable temperature 130°C(265°F)-220°C(430°F)
- ◆ Ceramic coating for friction free
- ◆ 2.5 meters 360° swivel cord
- ◆ Automatic shut-off in one hour
- ◆ Two conical barrel size: 13+25mm, 19+32mm
- ◆ Various barrel shapes and sizes available for choice



LM-201

Professional spring curling iron

- ◆ Dual voltage 100-240V AC
- ◆ Rapid heating up and constant recovery
- ◆ Temperature control from 120°C(250°F)-220°C(430°F)
- ◆ Ceramic coating for friction free
- ◆ 2.5 meters 360° swivel cord
- ◆ Automatic shut-off in one hour
- ◆ Various barrel size: 19mm, 25mm, 28mm, 32mm, 38mm
- ◆ Various barrel shapes and sizes available for choice



LM-209

Professional spring curling iron

- ◆ Dual voltage 100-240V AC
- ◆ Rapid heating up and constant recovery
- ◆ Ceramic coated tong for smooth hair
- ◆ LCD adjustable temperature 130°C(265°F)-220°C(430°F)
- ◆ 2.5 meters 360° swivel cord
- ◆ Automatic shut-off in one hour
- ◆ Various barrel size: 19mm, 25mm, 28mm, 32mm, 38mm
- ◆ Various barrel shapes and sizes available for choice



LM-210

Professional triplex curling iron

- ◆ Dual voltage 100-240V AC
- ◆ Rapid heating up and constant recovery
- ◆ Ceramic coated tong for smooth hair
- ◆ Temperature control from 140°C(285°F) - 160°C(320°F) - 180°C(355°F) - 200°C(395°F) - 220°C(430°F)
- ◆ 2.5 meters 360° swivel cord
- ◆ Automatic shut-off in one hour
- ◆ Various barrel size: 16mm, 19mm, 22mm
- ◆ Various barrel shapes and sizes available for choice





LM-211

Salon grade quality spring curling iron

- ◆ Dual voltage 100-240V AC
- ◆ Rapid heating up and constant recovery
- ◆ Ceramic coating for friction free
- ◆ Sliding ON/OFF with max temperature 220°C(430°F)
- ◆ 2.5 meters 360° swivel cord
- ◆ Various barrel size: 19mm, 22mm, 25mm, 28mm, 32mm, 38mm
- ◆ Various barrel shapes and sizes available for choice



LM-212S

NEW curling iron with ROTATING HANDLE

- ◆ Lock/unlock system for ultimate control and styling
- ◆ Tourmaline ceramic or titanium barrel
- ◆ Adjustable dial temperature, 280°F-330°F-380°F-430°F
- ◆ PTC heating element
- ◆ 2.5 meters 360° swivel cord
- ◆ Available barrel size: 16mm, 19mm, 25mm, 32mm
- ◆ Optional barrel: clip



LM-213(LED)/214(LCD)

INTERCHANGEABLE ceramic barrels for different use

- ◆ Two options of temperature display:
LED indicator, LCD screen
- ◆ Dual voltage 100-240V AC
- ◆ Rapid heating up and constant recovery
- ◆ Automatic shut-off in one hour
- ◆ 2.5 meters 360° swivel cord
- ◆ Various barrel size: 32mm tong, 32mm wand, 25mm tong, 25mm wand and 19mm tong



LM-219

Digital curling iron with new fast heating technology

- ◆ Fast heat-up and recovery by advanced heaters
- ◆ Tourmaline ceramic or titanium barrel
- ◆ Dual voltage 100-240V AC
- ◆ LED digital display, 130°C(265°F)-220°C(430°F)
- ◆ Negative ion function
- ◆ Automatic shut-off in one hour
- ◆ 2.5 meters 360° swivel cord
- ◆ Various barrels size:
19mm, 22mm, 25mm, 28mm, 32mm, 38mm





LM-158

Ceramic hair straightening brush

Product size: 250*59*43mm



LM-153

Hair straightening ceramic brush

- ◆ Dual voltage 100-240V AC
- ◆ MCH heating element
- ◆ Adjustable temperature 130°C(265°F)-220°C(430°F)
- ◆ LED Digital in real-time display
- ◆ Temperature lock function
- ◆ Automatic shut-off in one hour
- ◆ 1.8 meters 360° swivel cord
- ◆ Optional negative ion generating function
- ◆ Product size: 250*59*43mm

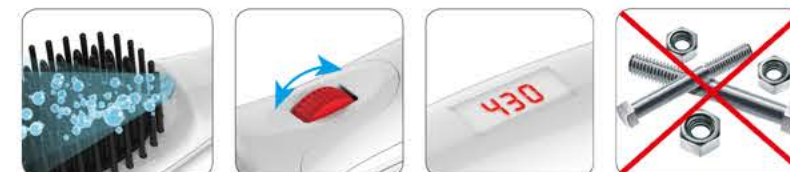

LM-157

Ceramic hair straightening brush

- ◆ Dual voltage 100-240V AC
- ◆ Ceramic coating for shiny and silky result
- ◆ PTC heating element
- ◆ 3 temperature levels 150°C(300°F)-180°C(355°F)-220°C(430°F)
- ◆ All-in-one button control for easy styling
- ◆ Automatic shut-off in one hour
- ◆ 1.8 meters cord for styling
- ◆ Optional negative ion generating function
- ◆ Product size: 250x59x43mm





LM-206

Thermal hair brush styler

- ◆ Dual voltage 100-240V AC
- ◆ MCH heating element
- ◆ Low temperature to less than 60 degree for safer touch
- ◆ Ceramic coating for shiny and silky result
- ◆ 5 temperature levels 120°C to 210°C/250°F to 410°F
- ◆ Automatic shut-off in one hour
- ◆ 2.5 meters 360°swivel cord
- ◆ Optional negative ion generating function
- ◆ Extra infra-red function
- ◆ Product size: 295*43*55mm



LM-216

Hot hair brush styler

- ◆ Single voltage, 100-127V/220-240V AC
- ◆ Ceramic coating for shiny and silky result
- ◆ PTC heating element
- ◆ Sliding ON/OFF switch with LED indicator
- ◆ Max temperature 200°C/392°F
- ◆ Cool front tip for safety touch
- ◆ Professional 360° swivel cord with no tangles
- ◆ Optional barrel sizes: 30mm, 40mm
- ◆ Optional negative ion generating function



LM-162

Travel size hair straightener 2/3"plate

Plate size: 17x70mm
Product size: 200x28x29mm





LM-138

Travel size hair straightener 2/3"plate

- ◆ Power voltage, 5V 12W
- ◆ LED indicators for three temperature levels L/M/H
- ◆ ON/OFF switch with heats to 160°C/180°C/200°C
- ◆ MCH heating element
- ◆ Tourmaline ceramic or nano titanium technology
- ◆ Lock function on the tail
- ◆ With standard charger or an extra car charger
- ◆ Product life over accumulated 500 hours
- ◆ Plate size: 24x80mm
- ◆ Product size: 207x42x37.5mm



LM-163

Travel size hair straightener 2/3"plate

- ◆ Dual voltage 100-240V AC
- ◆ 3D floating plates for easier styling
- ◆ Max temp 220°C/430°F
- ◆ PTC heating element
- ◆ Ergonomic and non-slip design
- ◆ 1.5 meters 360° swivel cord
- ◆ Lock function on the tail
- ◆ Plate size: 17x70mm
- ◆ Product size: 200x28x29mm



LM-168

Travel size hair straightener 2/3"plate

- ◆ Dual voltage 100-240V AC
- ◆ 3D floating plates for easier styling
- ◆ ON/OFF switch with max temperature 210°C/410°F
- ◆ PTC heating element
- ◆ Easy to handle, LED indicator light
- ◆ Plate size: 16x68mm
- ◆ Product size: 177x20x26mm





LM-211MS

MINI hair curling styler with 360° swivel cord

- ◆ Dual voltage 100-240V
- ◆ MINI SIZE curling iron for worldwide travel use and easy carry
- ◆ Ceramic coating for shiny and silky result
- ◆ PTC heating element
- ◆ Sliding ON/OFF with max temperature 210°C/410°F
- ◆ 1.5 meters 360° swivel cord
- ◆ Various size: 13mm tong, 16mm tong, 19mm tong, 10-16mm wand, 13-19mm wand



LM-401

NEW innovative brush

- ◆ Perfect for detangling, smoothing and taming
- ◆ Ionic function & interchangeable brush head
- ◆ Light weight, easy to carry and use
- ◆ Dry battery inside for ionic function
- ◆ Product size: 120*65*41mm



LM-405

Mini size travel thermal brush

- ◆ Dual voltage 100-240V AC 50/60Hz
- ◆ Ceramic coating for shiny and silky result
- ◆ PTC heating element
- ◆ ON/OFF switch with max temperature 210°C/410°F
- ◆ 1.5 meters cord for styling
- ◆ Product size: 210x50x34mm



Nano Fabric



◆ Silicone Sleeve



LM-S005

- ◆ Heat resistant up to 250°C
- ◆ Silicone soft material, environment friendly, scent-free
- ◆ Perfect from heat damage and easy storing
- ◆ Fits hair straighteners up to 1.5"

Color: 



◆ Holder

**LM-H003****Detachable Iron Holder/Stand**

- ◆ Heat-resistant, withstand hot temperature
- ◆ Quality sucker for strong stand
- ◆ Mount on wall or counter top
- ◆ Detachable, convenient storage and packing

LM-H001**LM-H002**

◆ Pouch

**LM-B001**

- ◆ Material: polyester+ silver foil
- ◆ Size: 30*9.5cm or customized

**LM-B002**

- ◆ Material: polyester+ PU leather
- ◆ Size: 30*13cm or customized

**LM-B003**

- ◆ Material: polyester+ silver foil
- ◆ Size: 34*20*5cm or customized

**LM-B004**

- ◆ Material: PU leather+zipper
- ◆ Size: 33*12cm or customized

◆ Pouch

**LM-B005**

- ◆ Material: polyester+ silver foil+zipper
- ◆ Size: 34*20*5cm or customized

**LM-B007**

- ◆ Material: polyester
- ◆ Size: 36*13cm or customized

**LM-B006**

- ◆ Material: non-woven fabric
- ◆ Size: 30*9.5cm or customized

**LM-B008**

- ◆ Material: Satin polyester+ drawstring
- ◆ Size: 30*9.5cm or customized

◆ Glove

**LM-G001**

- ◆ 100% cotton from heat damage

**LM-G002**

- ◆ Cotton gloves with rubber dimples
- ◆ Heat resistant up to 200°C/250°C

**LM-G003**

- ◆ Polyester from heat damage



◆ Plate, barrel & housing



Sizes: 19mm, 25mm, 28mm, 32mm,
35mm, 38mm

Finish: Tourmaline ceramic, titanium,
chrome titanium, nano silk fabric,
multi-colored chrome titanium

Sizes: 13mm, 19mm, 22mm, 25mm,
28mm, 32mm, 38mm

Finish: Tourmaline ceramic, titanium,
chrome titanium,
nano silk fabric



Finish: injection, rubberized painting,
spray painting in 1 color or multi-colors,
water-transfer painting,
water-transfer sticker,
electroplating



◆ Packing Box



Rectangular box



Sliding tray box



Tube box



PVC window box



Magnetic box



Lid and tray giftbox